

# Plan for **this** office and retail space

this space - a Mount Anvil development

*Flexible retail and office space on the ground floor*



- Unit 1 GF = 590 m<sup>2</sup> - A1 (B1/D1\*)
- Unit 1 LGF = 288 m<sup>2</sup> - A1 (B1/D1\*)
- Unit 2 GF = 732 m<sup>2</sup> - A3/A4 (B1/D1\*)
- Unit 3 GF = 689m<sup>2</sup> - B1 (D1\*)
- Unit 4 GF = 724m<sup>2</sup> - A3/A4 (B1/D1\*)
- Unit 5 GF = Unit Let
- Unit 5 LGF = Unit Let
- Unit 6 GF = 79m<sup>2</sup> - A1 (B1/D1\*)
- X
 Lifts
- LGF Lower ground floor
- GF Ground floor
- NOTE: Units can be combined or sub-divided\*
- \*Subject to planning

# Plan for **this** office and retail space

this space - a Mount Anvil development

*Flexible retail and office space on the lower ground floor*

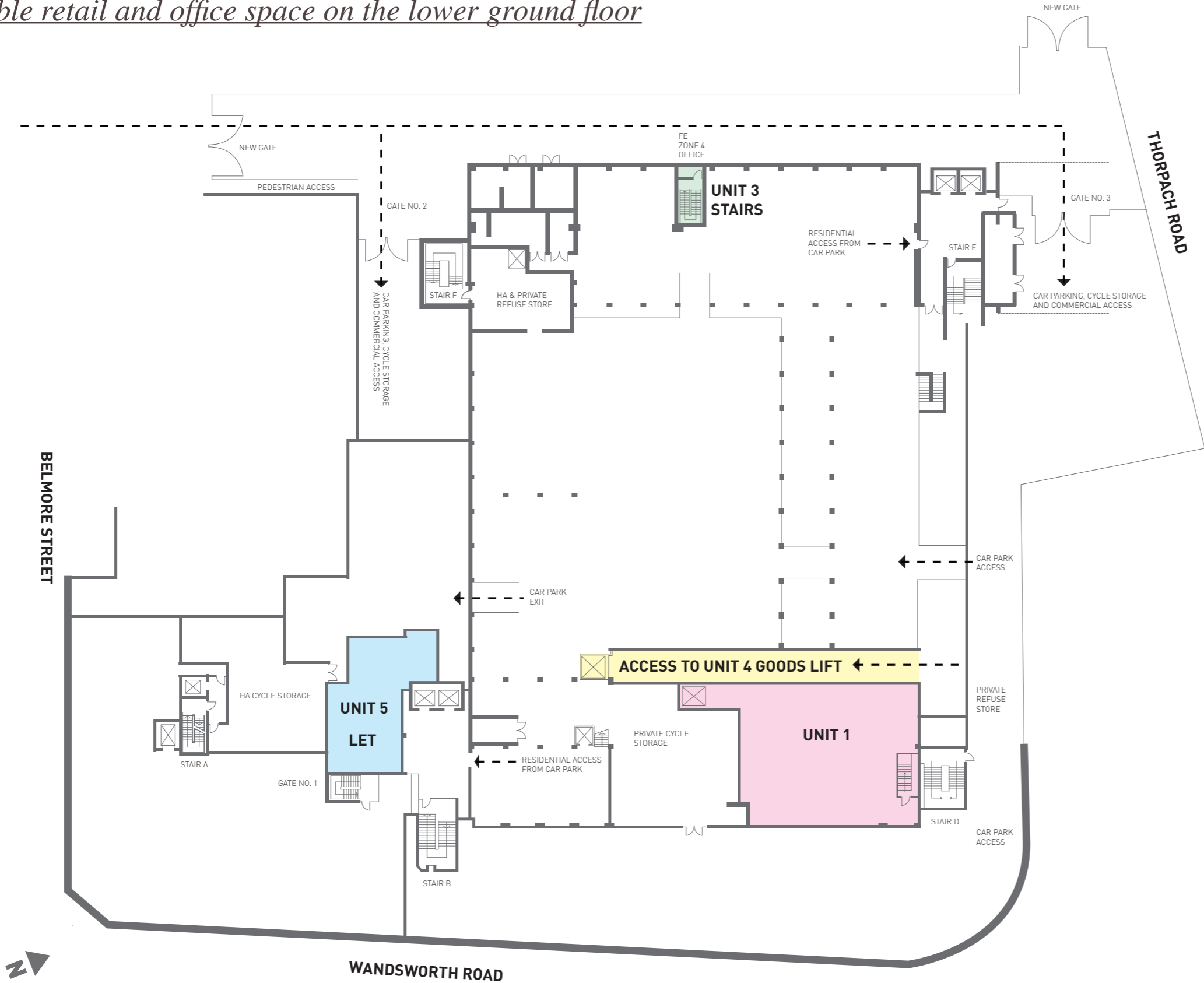

- Unit 1 GF = 590 m<sup>2</sup> - A1 (B1/D1\*)
- Unit 1 LGF = 288 m<sup>2</sup> - A1 (B1/D1\*)
- Unit 2 GF = 732 m<sup>2</sup> - A3/A4 (B1/D1\*)
- Unit 3 GF = 689m<sup>2</sup> - B1 (D1\*)
- Unit 4 GF = 724m<sup>2</sup> - A3/A4 (B1/D1\*)
- Unit 5 GF = Unit Let
- Unit 5 LGF = Unit Let
- Unit 6 GF = 79m<sup>2</sup> - A1 (B1/D1\*)

Lifts

LGF Lower ground floor

GF Ground floor

NOTE: Units can be combined or sub-divided\*

\*Subject to planning

All measurements are approximate and subject to planning.